

CABLE CORE TWISTERS

COMPLIES WITH THE DIELECTRIC TESTING OF IEC 60900-1

Manufactured in Acetal (International Orange). Used to manipulate bare or insulated cable cores to align the cores prior to jointing. The shapes of the recesses of the cores are used to suit the different segmental shapes of 3 and 4 core cable.

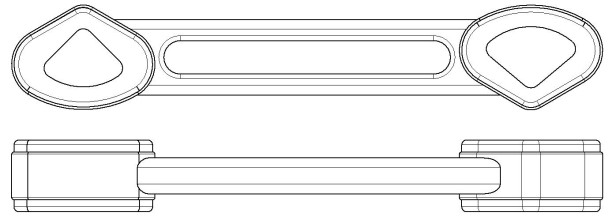

INDIVIDUAL PART DRAWINGS CAN BE SUPPLIED ON REQUEST

3 CORE

PART NO.	CORES	CORE RANGE SIZE (mm ²)	PACK QTY.	WEIGHT (g)
110-95C	3	70 BARE X 95 BARE	10	54
110-X01C	3	95 BARE X 95 INS	10	51
110-120C	3	70 BARE X 120 BARE	10	51
110-120IC	3	70 INS X 120 INS	10	49
110-X06C	3	120 BARE X 120 INS	10	48
110-X07C	3	185 BARE X 185 INS	10	148
110-240C	3	185 BARE X 240 BARE	10	146
110-300C	3	185 BARE X 300 BARE	10	147
110-300IC	3	185 INS X 300 INS	10	139
110-X08C	3	300 BARE X 300 INS	10	138
110-X09C	3	70 BARE X 70 INS	10	53
110-X10C	3	95 BARE X 185 BARE	10	154
110-X11C	3	95 INS X 185 INS	10	149

3 & 4 CORE

PART NO.	CORES	CORE RANGE SIZE (mm ²)	PACK QTY.	WEIGHT (g)
110-X03C	3 & 4	3C 95 INS X 4C 95 INS	10	50
110-X04C	3 & 4	3C 185 INS X 4C 185 INS	10	145
110-X05C	3 & 4	3C 300 INS X 4C 240 INS	10	135
110-X12C	3 & 4	3C 300 BARE X 4C 300 BARE	10	141
110-X13C	3 & 4	3C 300 INS X 4C 300 INS	10	134

4 CORE

PART NO.	CORES	CORE RANGE SIZE (mm ²)	PACK QTY.	WEIGHT (g)
110-41C	4	95 BARE X 95 INS	10	51
110-42C	4	185 INS X 240 INS	10	142
110-43C	4	185 BARE X 240 BARE	10	150
110-44C	4	185 INS X 300 INS	10	141
110-48C	4	120 INS X 185 INS	10	150
110-X02C	4	185 BARE X 300 BARE	10	146
110-X14C	4	95 BARE X 185 BARE	10	155
110-X15C	4	95 INS X 185 INS	10	149
110-16C	4	95 INS STRANDED X 95 INS SOLID	10	51
110-17C	4	300 INS STRANDED X 300 INS SOLID	10	140

ELLIS

Holding Power

DATA SHEET

CORE TWISTERS, WEDGES & GUARDS

CABLE CORE GUARDS

Manufactured in Nylon (International orange). Used to provide separation between a cable core which is being cut and neighbouring cores.

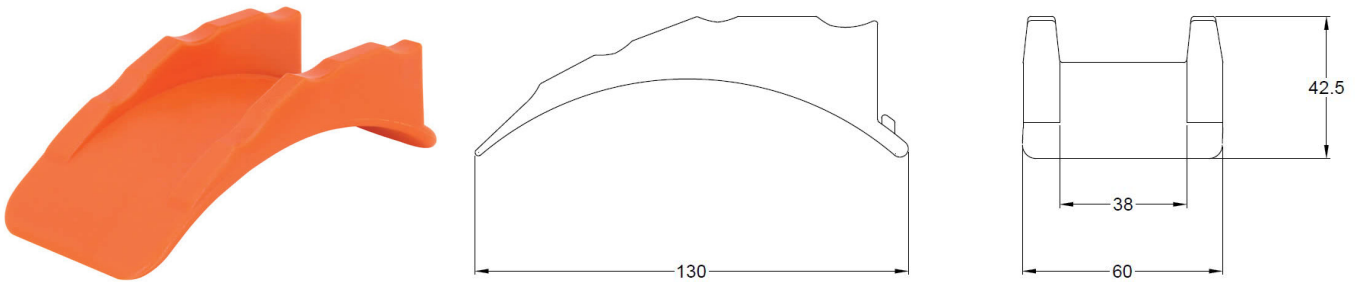

PART NO.	NOMINAL LIFT (mm)	PACK QTY.	WEIGHT (g)
120-CG1C	23	10	57

CABLE CORE GUARDS

Manufactured in Nylon (International orange). Used to prise apart and to separate the cores of cables.

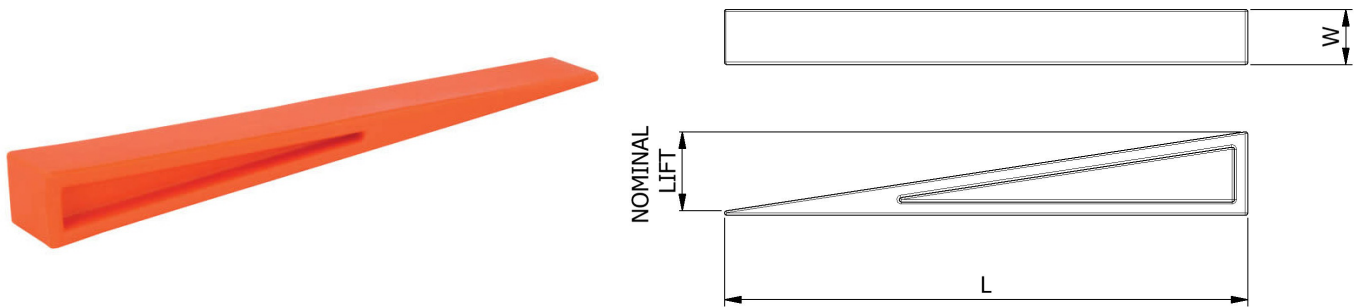

PART NO.	DIMENSIONS (mm)			PACK QTY.	WEIGHT (g)
	L	W	NOMINAL LIFT		
110-1NYC	150	25	15	10	41
110-2NYC	225	25	25	10	65
110-3NYC	225	25	38	10	89
110-4NYC	150	13	25	10	32

This data sheet is subject to change without notice. The information provided has been generated in laboratory conditions, as such results in use may vary.

ELLIS PATENTS LTD.

www.ellispatents.co.uk

ISSUE 01 11/04/19

2 / 2