

## Industrial Cableclamp Data Sheet

17 Series Industrial Cableclamp is available in Black LLDPE or Black Polymeric LSF (low smoke and fume) material, suffix 'LUL'

Material data sheets for : Black LLDPE and Black Polymeric LUL (LSF) are available upon request.

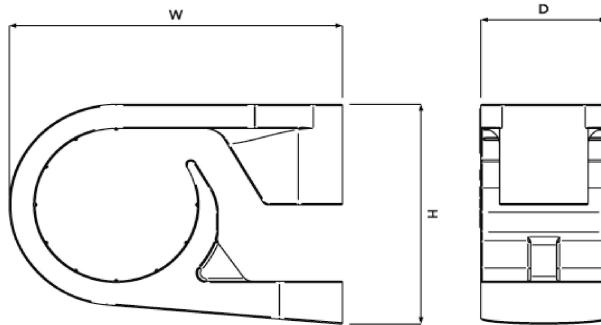

### Selection Table

| Part No. |          | Cable Range |            | Dimensions mm |      |    |             | Pack Qty | SWL kgf | Weight g |      |
|----------|----------|-------------|------------|---------------|------|----|-------------|----------|---------|----------|------|
| LLDPE    | LUL      | Min dia mm  | Max dia mm | W             | H    | D  | Fixing Hole |          |         | LLDPE    | LUL  |
| 17-01B   | 17-01LUL | 10          | 15         | 27.8          | 17.6 | 12 | 4.3         | 100      | 18      | 2.0      | 3.5  |
| 17-02B   | 17-02LUL | 12          | 17         | 32.0          | 20.8 | 14 | 4.3         | 100      | 24      | 3.3      | 5.4  |
| 17-03B   | 17-03LUL | 15          | 20         | 37.1          | 25.3 | 16 | 4.3         | 100      | 32      | 5.2      | 8.6  |
| 17-04B   | 17-04LUL | 18          | 24         | 41.0          | 29.6 | 18 | 4.3         | 100      | 39      | 7.3      | 12.2 |
| 17-05B   | 17-05LUL | 22          | 29         | 52.1          | 35.4 | 20 | 6.5         | 50       | 52      | 11.2     | 18.6 |
| 17-06B   | 17-06LUL | 26          | 34         | 58.2          | 40.9 | 22 | 6.5         | 50       | 66      | 16.5     | 27.9 |
| 17-07B   | 17-07LUL | 32          | 42         | 69.3          | 49.2 | 25 | 6.5         | 25       | 79      | 25.6     | 42.9 |
| 17-08B   | 17-08LUL | 39          | 51         | 81.7          | 58.5 | 26 | 6.5         | 25       | 93      | 36.2     | 60.1 |

The LUL version of this clamp is compliant with the requirements of London Underground Standard 1-085. Product Register No. 365