



# TRIDENT™

## INSTALLATION INSTRUCTIONS

---

1) If the cleat is being fixed with 1 x M12 fixings, see 1a, if it is being fixed with 2 x M10/M12 see 1b.

1a) Feed the closure fixings through the base of the cleat into the hex recesses. Place then the cleat on the mounting structure and fix the cleat from below using 1x M12 fixings through the central hole.



1b) Place the base of the cleat on mounting surface and feed the 2 x M10 or M12 fixings through the base of the cleat (product size dependent) and the mounting structure.

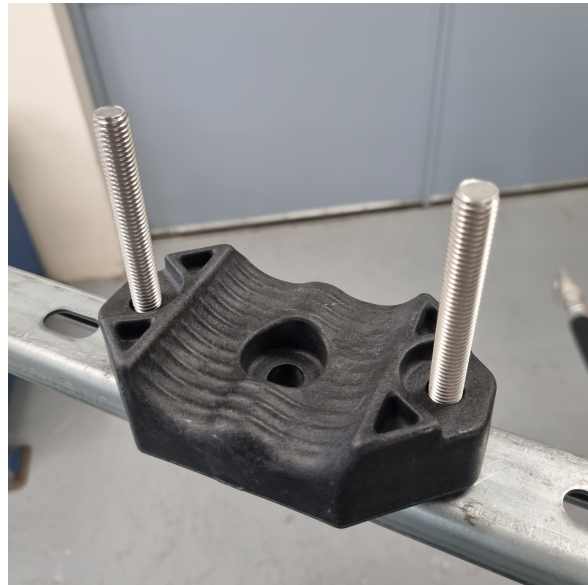

3) Lay the cable on the base on the cleat.



4) Place top of the cleat on the base. Tighten the closure nuts to a **maximum torque of 10N.m**. Ensure that the nuts are tightened equally to ensure that the top is installed straight  
Note: Do not over tighten the cleat. The cleat should secure the cable but doesn't need to be over tightened that the cable bulges on each side of the cleat.



### Torque

Nuts need to be tightened in a maximum torque of 10Nm. This is based on the strength of the clamp rather than the cable installed within. See the item 4 of Ellis' guidelines on clamped cables.